

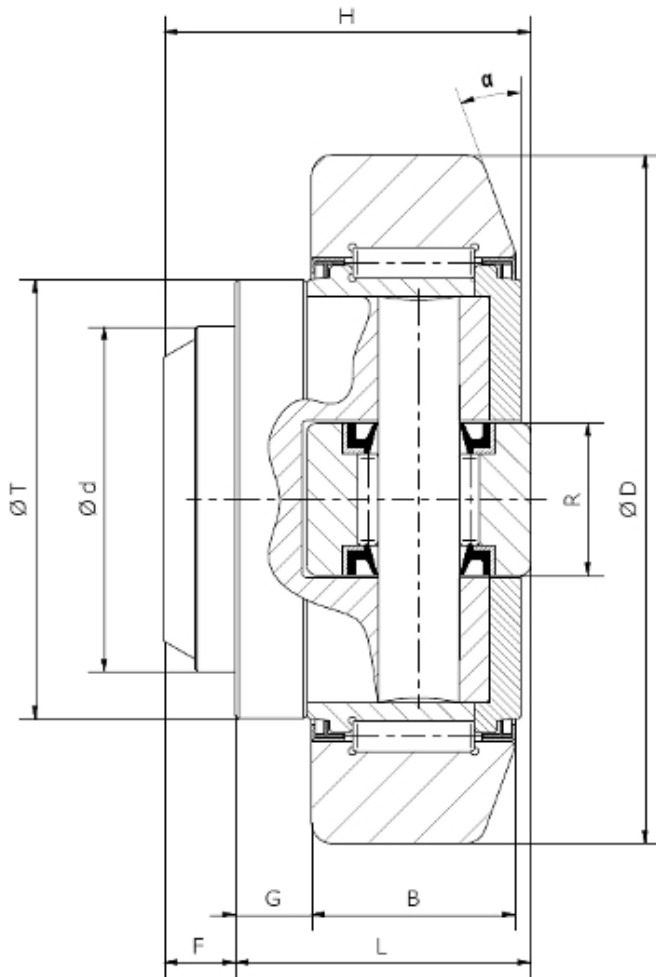

FIXED COMBINED BEARINGS FOR "C" SHAPE CALIBRATED SECTIONS



MATERIAL	
External rings	STEEL UNI 17MnCr5 DIN 17MnCr5 / WNr.1.3521 (CTRs 58±60HRc)
Interior rings	STEEL UNI 100Cr6 DIN 100Cr6/ WNr.1.3505 (TRs 60±62 HRc)
Rolling bodies	STEEL UNI 100Cr6 DIN 100Cr6/ WNr.1.3505 (TRs 61±63 HRc)
Main pin	UNI Fe510.C DIN St 52.3/ WNr. 1.0553
DIMENSIONAL TOLERANCES, RADIAL CLEARANCE, LOAD CAPACITY	
Processing tolerance	On DIN 620.
Precision class	P "O".
Radial clearance	On DIN 620.
Load factors	Calculated on DIN - ISO 281/1/ DIN - ISO 76.

	Size										Load capacity				Weight KG	PROFILE-TYPE
	TYPE 2 ZRS	d mm	D mm	H mm	B mm	G mm	L mm	F mm	T mm	R mm	α	C KN	C ₀ KN	C _A KN		
MR.021/S*	30	64,8	37,5	20	8	30,5	7	42	20	20°	31	35,5	11	11,5	0,55	EC065L
MR.022/S	35	73,8	44	23	10,5	36	8	48	22	20°	45,5	51	14	13	0,85	EC074L
MR.023/S	40	81,8	48	23	10,5	36,5	11,5	54	24	20°	48	56,8	18	18	1,10	EC082L
MR.025/S	45	92,8	57	30	10,5	44	13	59	26	20°	68	72	23	23	1,70	EC093L
MR.027/S	60	111,8	69	31	20	55	14	71	34	20°	81	95	31	36	2,95	EC112L
MR.029/S	60	127,8	72,3	37	14	56	16,3	80	40	20°	110	132	43	50	4,10	EC128L
MR.030/S	60	153,8	78,5	43	10,5	58,5	20	103	50	15°	151	192	68	71	6,85	EC154L

*Not greaseable bearings